

TOMAN ENGINEERING COMPANY
CONSULTING CIVIL & ENVIRONMENTAL ENGINEERS

906 2ND ST. N.W. • MANDAN, NORTH DAKOTA 58554 • 701-663-6483 • FAX 701-663-0923

Memo

SAMPLE ONLY

To: Bill Augustadt
From: Ronald W. Manchester
CC: Steve McCormick, John Myers
Date: 10/6/2005
Re: Misty Waters TECO #4186

Typical Foundation Wall and Footing Design

Enclosed are the calculations and design for a typical wall and footing for a house located in the Misty Waters Subdivision. The typical wall design is a minimum requirement for all homes located in the Misty Waters Subdivision. All homeowners are recommended to conduct their own soils investigation and to have the foundation for their home to be designed by a registered professional engineer of their choice. All window and door openings shall have a minimum of 2 #5 bars around them and extending a minimum of 24 inches past the openings. An assumed wall loading of $w_o = 3,000$ lb/ft and $w_l = 1,000$ lb/ft was used in the design of the minimum foundation requirements. It is also recommended to all homeowners that they install drain tile around their footings and to have a sump pump installed in their basement or crawl space. The lowest allowable elevation for the bottom of the footing is 1635.00 (NGVD29 Datum).

Respectfully,

Ronald W. Manchester

**TYPICAL WALL SECTION
PLAN VIEW**

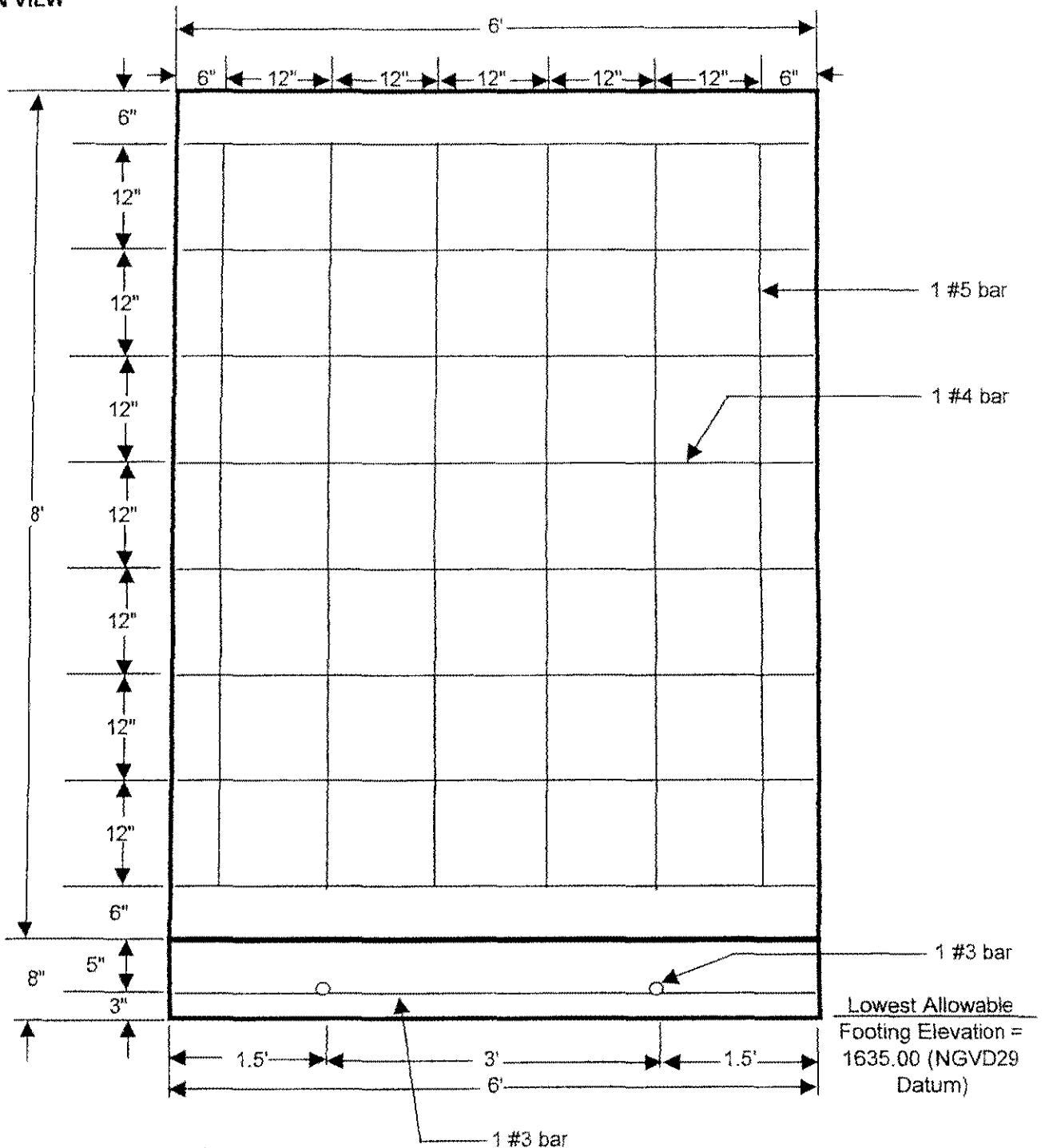

Note: All window and door openings shall have a minimum of 2 #5 bars around them and extending a minimum of 24 inches past the openings. An assumed wall loading of $w_D = 3,000$ lb/ft and $w_L = 1,000$ lb/ft was used in the design of the minimum foundation wall requirements.

The typical wall design is a minimum requirement for all homes located in the Misty Waters Subdivision. All home owners are recommended to conduct their own soils investigation and to have the foundation for their home to be designed by a registered professional engineer of their choice.

TYPICAL WALL SECTION
SIDE VIEW

